



Golden Orchid | Studio Apartments



Golden Orchid is located along Jurong West Street 41. This 17-storey development comprises 232 Studio Apartments. With Hong Kah Ville neighbourhood centre and Jurong Green Community Club sited nearby, you are set to enjoy plenty of shopping, dining and recreational options conveniently.

This development is named “Golden Orchid” as the orchid flowers personify timeless elegance while the word ‘Golden’ connotes growing old gracefully. The building façade is designed in an elegant white accentuated with maroon tones, reflecting the colours often seen on orchids.



A comfortable habitat

Golden Orchid features a white facade decorated with bands of vibrant colours to exude a modern and refreshing look. Golden Orchid is designed to allow residents to enjoy the green spaces created around the residential block. Do some stretching exercises on the open lawn, while keeping an eye on the children playing at the play area. The elderly can get a workout at the fitness station designed for them. Pursue group activities such as line dancing in the shelter of the precinct pavilion.



Golden Orchid is also equipped with support grab bars at common areas and ramps which assist residents in moving around the development. Each Studio Apartment is also provided with elderly-friendly grab bars. These units will come in a ready-to-move-in condition, complete with a built-in wardrobe and kitchen cabinets. Moving in will be hassle-free.



Amenities within reach

Golden Orchid is located conveniently next to Hong Kah Ville neighbourhood centre which hosts a mix of eating outlets and retail trades to meet your day-to-day needs. Find out more about this neighbourhood centre and other HDB heartland shops in Jurong West at Where2Shop@HDB.

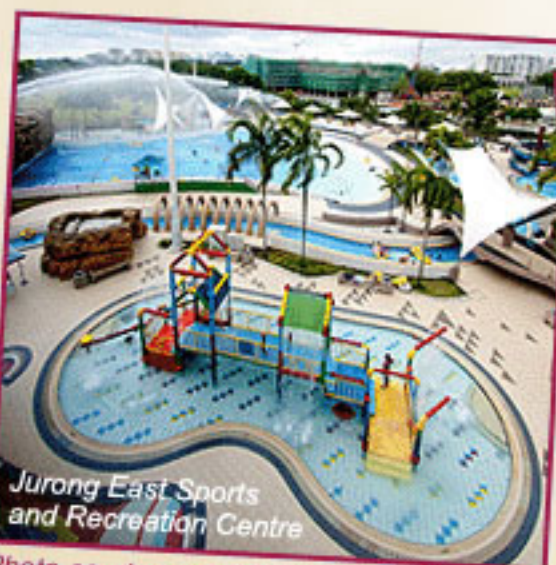

Photo courtesy of Singapore Sports Council



For leisure, stroll over to the nearby Jurong Green Community Club. Pick up a new hobby while having fun and making new friends. Other recreational spots in the town include Jurong East Sports and Recreation Centre, Jurong Lake Park, Chinese Garden and Japanese Garden.

Easy commuting is provided by Lakeside MRT station and bus services. Those who drive are well-connected by expressways.

The range of schools in the town includes Shuqun Primary School, Yuhua Secondary School, Fuhua Secondary School, River Valley High School and Jurong Junior College.





A delightful selection

Choose from 232 Studio Apartments. These Studio Apartments are designed specially to meet the needs of those 55 years old and above. At a size of 35 sqm or 45 sqm, each apartment will be in ready-to-move-in condition and is furnished with essentials such as elderly-friendly fixtures, ceramic floor tiles, a built-in wardrobe, kitchen cabinets and more. These units come with three-quarter height windows in the living/dining area, as well as in the bedrooms.

The indicative price range of these Studio Apartments is tabulated below.

Flat Type	Floor Area (sqm)	Internal Floor Area (sqm)	No. of Units	Indicative Price Range (\$)
Studio Apt	37	35	94	\$83,000 - \$94,000
	47	45	138	\$103,000 - \$115,000

Notes:

- (a) Floor area refers to the estimated area of the whole apartment, inclusive of the area of air-conditioner ledge.
- (b) Internal floor area refers to the estimated area of the apartment computed based on the centre line of the apartment wall.
- (c) The indicative prices do not include the cost of optional components. Actual selling prices will vary according to the attributes of the individual units at the time of selection.
- (d) Studio Apartments are sold on 30-year lease. Prices are inclusive of the elderly-friendly fittings/finishes.

Estimated Completion Date and Waiting Time

Housing Development	Golden Orchid
Selection Date (Median Month of Selection)	Aug 2011 to Jan 2012 (Nov 2011)
Estimated Completion Date	2nd Quarter 2014
Estimated Waiting Time	30 months

Notes:

- a) The waiting time is computed based on the median month of selection exercise.
- b) The actual completion date will depend on the progress of the construction.
- c) The Estimated Delivery Possession Date (EDPD) is 30 Apr 2015 for Golden Orchid. The EDPD is an estimation of the date that HDB is required under the Agreement for Lease to deliver possession of the flat. Applicants will be informed the Actual Delivery Possession Date during the signing of the Agreement for Lease.

Typical Floor Plans



TYPICAL STUDIO APARTMENT (TYPE A) FLOOR PLAN
APPROX. FLOOR AREA 37 sqm
(Inclusive of Internal Floor Area 35 sqm and Air-Con Ledge)

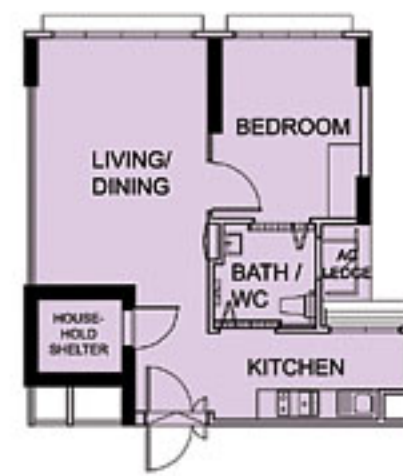

TYPICAL STUDIO APARTMENT (TYPE B) FLOOR PLAN
APPROX. FLOOR AREA 47 sqm
(Inclusive of Internal Floor Area 45 sqm and Air-Con Ledge)

The coloured floor plans are not intended to demarcate the boundary of the flat.

Samples of Furnished Layout Plans



TYPICAL STUDIO APARTMENT (TYPE A) FLOOR PLAN
APPROX. FLOOR AREA 37 sqm
(Inclusive of Internal Floor Area 35 sqm and Air-Con Ledge)



TYPICAL STUDIO APARTMENT (TYPE B) FLOOR PLAN
APPROX. FLOOR AREA 47 sqm
(Inclusive of Internal Floor Area 45 sqm and Air-Con Ledge)